

## Support

To access support within the Ruskin app, navigate to **Help > Comment on Ruskin...**

For technical support, please reach out to [support@rbr-global.com](mailto:support@rbr-global.com), call +1 613 599 8900 (UTC-5), or visit [rbr-global.com/support/service](http://rbr-global.com/support/service).



# RBR

MEASURE THE BLUE PLANET

rbr-global.com

RBRquartz<sup>3</sup> Q

## QUICK START GUIDE



The RBRquartz<sup>3</sup> Q uses an integrated Paroscientific Digiquartz<sup>®</sup> pressure sensor. It offers a flexible measurement schedule, standard and burst sampling, large memory, and sufficient power for extended deployments. The RBRquartz<sup>3</sup> Q offers a variety of interfaces, including an internal USB-C port and an optional external port, which can be configured as USB, RS-232, or RS-485.

### Included with your instrument

- ▶ USB-C desktop cable with adaptor
- ▶ O-rings, silicone compound, O-ring removal tool, and reusable desiccant
- ▶ Refill adaptor, syringe with stopper, dispensing needle, syringe kickstand, and buffer fluid
- ▶ External pressure adaptor
- ▶ Cap screws and hex keys
- ▶ USB stick containing Ruskin software and documentation
- ▶ Calibration certificates\*

\*Calibration certificates are available in Ruskin. To download, connect your instrument, go to **Information**, and select the **Download** button.

## Ruskin software

Find Ruskin software for Mac and PC on the USB stick included with your instrument, or visit [rbr-global.com/products/software](http://rbr-global.com/products/software).

## Deploy

*Note: RBR ships all instruments preconfigured to sample at the fastest available rate, with twist activation enabled, and the battery end-cap set to **PAUSE**.*

1. Turn the battery end-cap to the **RUN** position. The instrument will vibrate with **one long pulse** to indicate it has started sampling.
2. Deploy the instrument.
3. To pause logging, turn the battery end-cap to the **PAUSE** position. The instrument will vibrate with **three short pulses** to indicate it has stopped sampling.

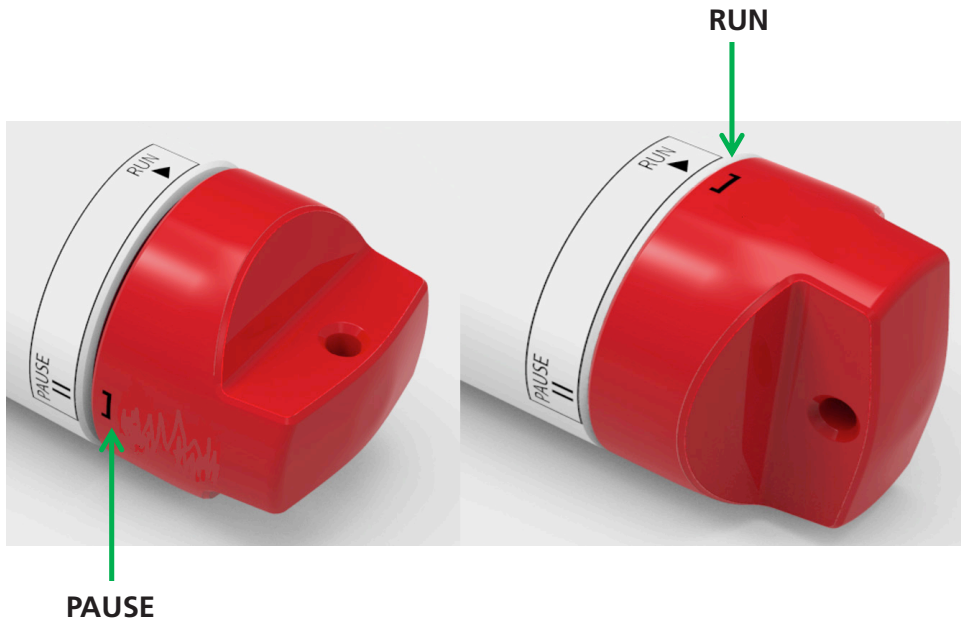

## Download

1. Fully unscrew and remove the battery end-cap.

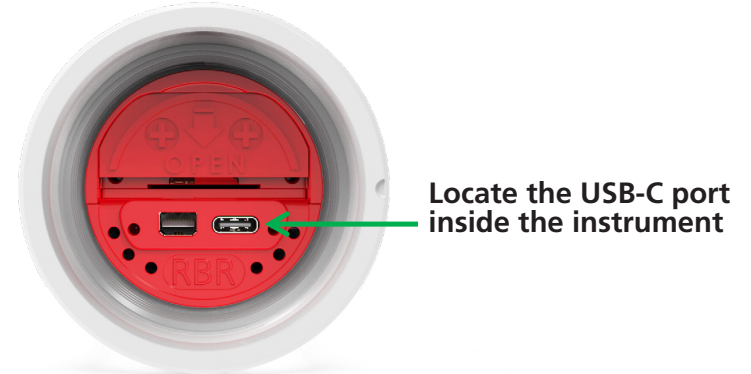

2. Connect the USB-C desktop cable to the USB-C port. The instrument will appear on Ruskin.
3. Click **Download...** and choose a location to store the dataset.

## Deployment checklist

RBR ships all instruments with new, highest capacity batteries and fresh desiccant capsules included, and the O-ring installed, so that the instrument is ready for its first deployment.

For any subsequent deployment:

1. Install new batteries.
2. Install fresh desiccant (orange).
3. Inspect, clean, replace, and lubricate the O-ring.

*Note: Always remove the batteries from the instrument during long-term storage! Doing so will prevent internal damage due to battery leakage and/or corrosion.*